

FISHER & PAYKEL

DATA SHEET

Built Under Recessed Tall, 24"

Model nos:

DW24UNT2X2

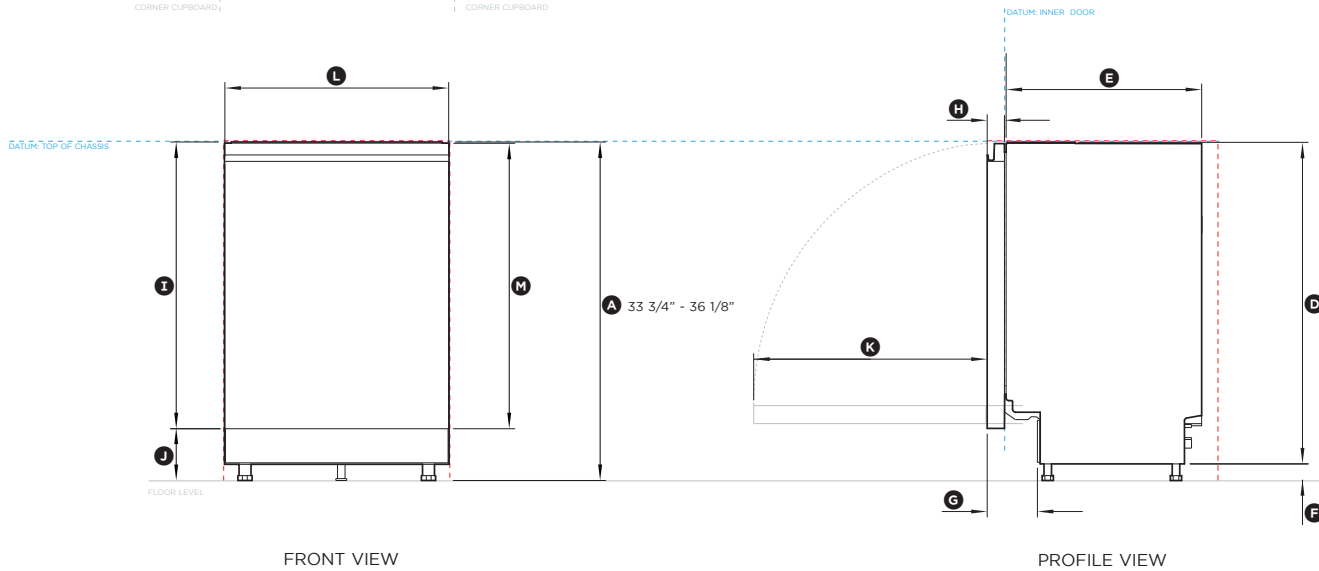
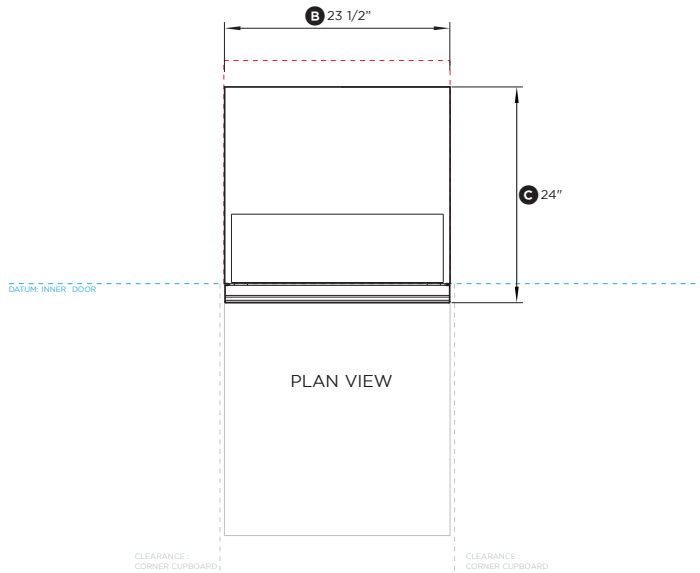
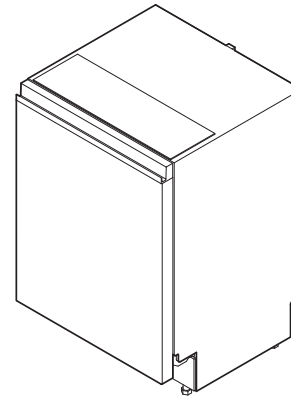

Product Dimensions

	in	mm
Ⓐ Overall height of product*	33 3/4" - 36 1/8"	857-917
Ⓑ Overall width of product**	23 1/2"	597
Ⓒ Overall depth of product (incl. stainless steel panel)	22 5/8"	574
Ⓓ Height of chassis	33 3/4"	857
Ⓔ Depth of chassis	20 1/2"	521
Ⓕ Height of feet*	0 - 2 3/8"	0-60
Ⓖ Depth of toe kick recess	5 3/8"	136
Ⓖ Door panel depth	1 13/16"	46
Ⓗ Height from top of chassis to bottom door panel	30"	762
Ⓘ Height from floor to door panel base*	3 9/16" - 5 15/16"	90-150
Ⓚ Depth of door opening	25 13/16"	656
Ⓛ Door panel width	23 7/16"	595
Ⓝ Door panel height	29 7/8"	759

*Depending on adjustment of levelling feet
**Excluding side seals

Minimum Clearances

	in	mm
Minimum inside height of cavity*	33 3/4"	857
Minimum inside width of cavity	23 5/8"	600
Minimum overall depth of cavity	22 13/16"	580
Minimum clearance to corner cupboard	1/2"	13
Minimum clearance to adjacent cupboard door	1/16"	2

*Depending on adjustment of levelling feet

INDICATES PRODUCT DATUM -----
INDICATES CABINETRY CLEARANCES -----

DATE: 05.07.2023

90002974A

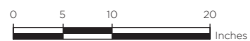

IMPORTANT NOTE: Throughout this guide, dimensions may vary by ±2mm (1/16"). Please read the installation guide for detailed information on installing the product. For full installation instructions & specifications visit fisherpaykel.com