

900mm Integrated DishDrawer™ Wide

Model no:

DD90ST12

DD36ST12 (refer page 2 for imperial measurements)

Product Dimensions	mm
Ⓐ Overall height* of DishDrawer™	458
Ⓑ Overall width* of DishDrawer™	855
Ⓒ Depth of DishDrawer™ chassis	553
Ⓓ Depth of drawer (open) (measured from front datum)	527

* Does not include the custom drawer panel or handle to be manufactured and fitted by cabinetmaker.

Note: Service outlet at rear extends both sides, hoses and cords can be routed to either or both.

Minimum Clearances	mm
Minimum inside height of cavity from bottom datum	460
Minimum inside width of cavity	864
Minimum inside depth of cavity from front datum	560
Minimum height of ventilation gap under custom drawer panel with external venting kit installed	2
Minimum gap from top of custom drawer panel to bottom of benchtop	2
Front carcass offset, cabinetry set back to allow drawer front to close hard against chassis. For a detailed view refer to cabinetry dimensions within installation manual.	2

INDICATES CABINETRY CARCASS DATUM -----
INDICATES MINIMUM CABINETRY CLEARANCES - - - - -

DATE: 14.03.2013

IMPORTANT NOTE: Throughout this guide, dimensions may vary by $\pm 2\text{mm}$ (3/32"). Please read the installation manual for detailed information on installing the product. www.fisherpaykel.com

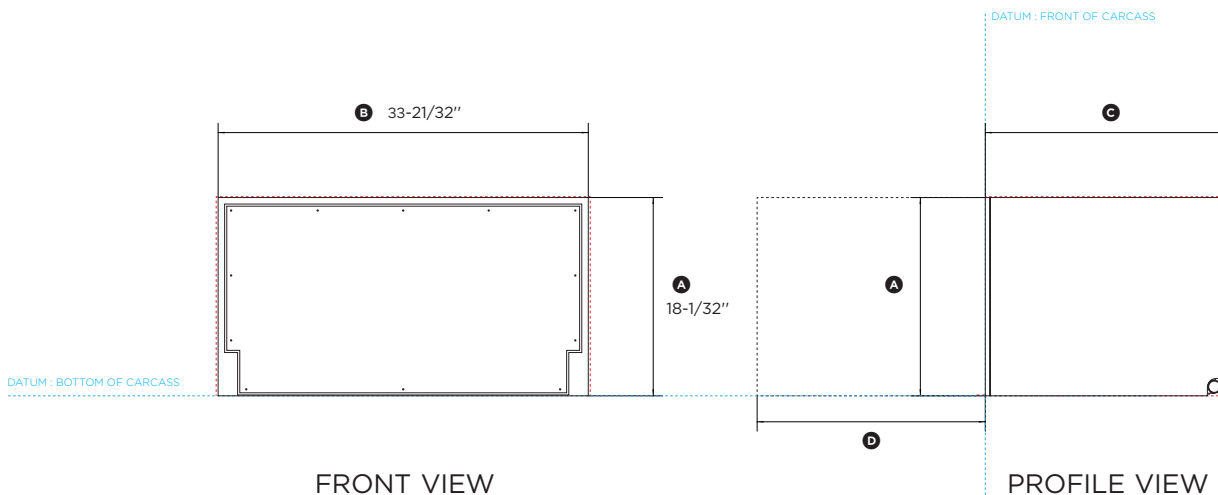
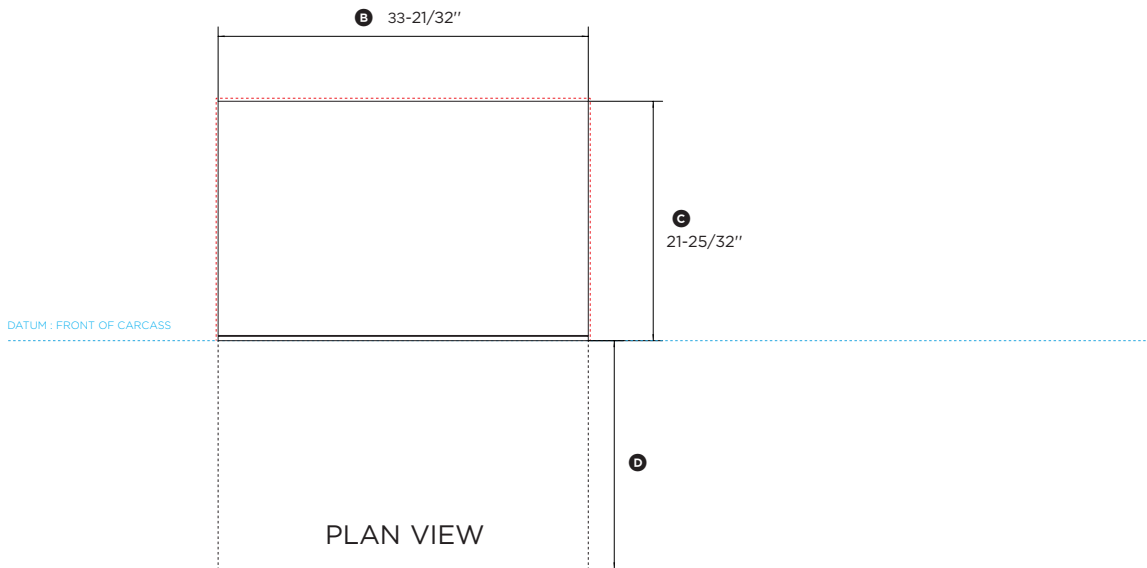

36" Integrated DishDrawer™ Wide

Model no:

DD90ST12 (refer page 1 for metric measurements)

DD36ST12

Product Dimensions	in
Ⓐ Overall height* of DishDrawer™	18-1/32"
Ⓔ Overall width* of DishDrawer™	33-21/32"
Ⓒ Depth of DishDrawer™ chassis	21-25/32"
Ⓓ Depth of drawer (open) (measured from front datum)	20-3/4"

* Does not include the custom drawer panel or handle to be manufactured and fitted by cabinetmaker.

Note: Service outlet at rear extends both sides, hoses and cords can be routed to either or both.

Minimum Clearances	in
Minimum inside height of cavity from bottom datum	18-1/8"
Minimum inside width of cavity	34-1/32"
Minimum inside depth of cavity from front datum	22-1/16"
Minimum height of ventilation gap under custom drawer panel with external venting kit installed	3/32"
Minimum gap from top of custom drawer panel to bottom of benchtop	3/32"
Front carcass offset, cabinetry set back to allow drawer front to close hard against chassis. For a detailed view refer to cabinetry dimensions within installation manual.	3/32"

INDICATES CABINETRY CARCASS DATUM

INDICATES MINIMUM CABINETRY CLEARANCES

DATE: 14.03.2013

IMPORTANT NOTE: Throughout this guide, dimensions may vary by ±2mm (3/32"). Please read the installation manual for detailed information on installing the product. www.fisherpaykel.com

Fisher & Paykel