

FISHER & PAYKEL

DATA SHEET 600mm Oven

Model no:
OB60SC8DEPX2, OB60SC7CEPX2, OB60SC6CEPX2

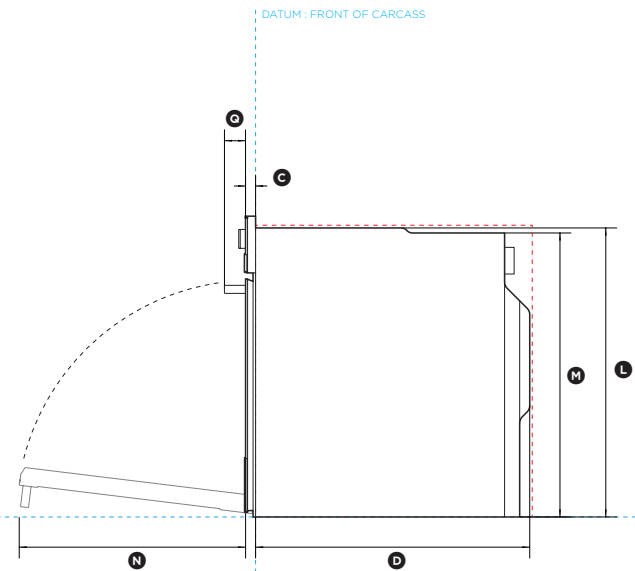
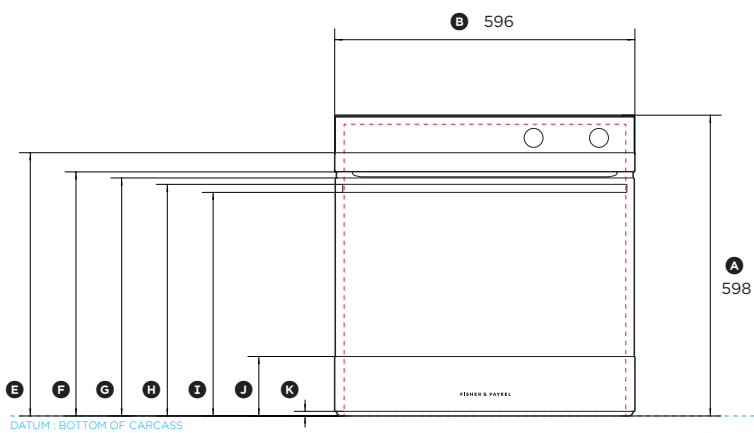
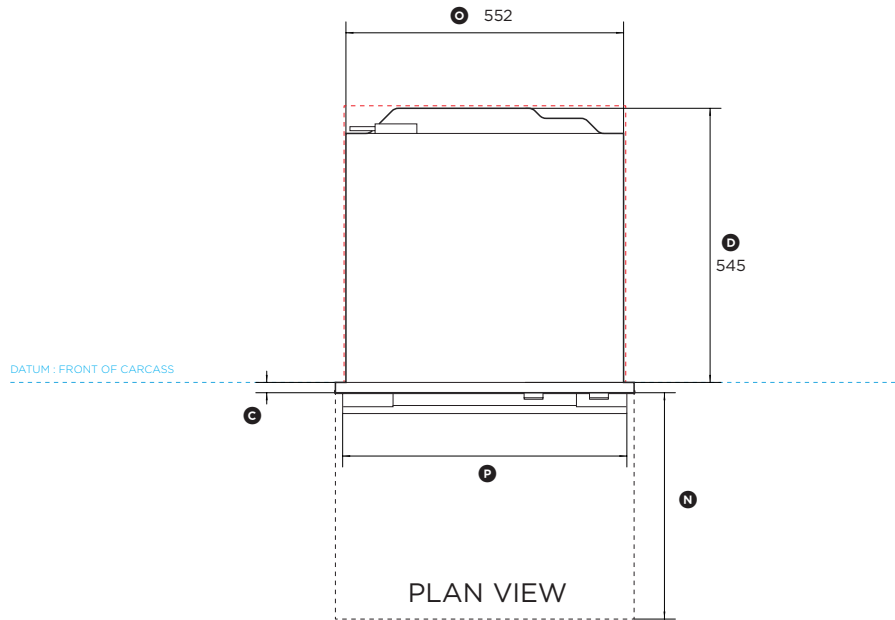

Product Dimensions	mm
(A) Overall height* of oven	598
(B) Overall width of oven	597
(C) Depth of oven front and control panel** (excludes handle and dials)	20
(D) Depth of oven chassis (does not include oven front)	545
(E) Height from bottom datum to top of stainless cap	523
(F) Height from bottom datum to bottom of stainless cap	485
(G) Height from bottom datum to top of door	473
(H) Height from bottom datum to top of handle	460
(I) Height from bottom datum to bottom of handle	445
(J) Height from bottom datum to top of stainless door cap	118
(K) Height from bottom datum to bottom of door	10
(L) Height from bottom datum to top of chassis	575
(M) Height from bottom datum to top of chassis at rear	565
(N) Depth of door (open) (measured from front of door)**	450
(O) Overall width of chassis	552
(P) Width of handle	565
(Q) Depth of handle (measured from front of door)**	42

* All height measurements included mounted feet

** Measured to front glass surface and excludes 2mm stainless cap

Minimum Clearances	mm
Height of cavity from bottom datum	580
Minimum inside width of cavity	560
Minimum inside depth of cavity from front datum	550

IMPORTANT NOTE: For full installation and clearance details please refer to our installation manual.

INDICATES PRODUCT DATUM -----
INDICATES CABINERY CLEARANCES - - - - -

DATE: **21.02.2019**

IMPORTANT NOTE: Throughout this guide, dimensions may vary by $\pm 2\text{mm}$ (1/16"). Please read the installation manual for detailed information on installing the product. For full installation instructions & specifications visit fisherpaykel.com