

FISHER & PAYKEL

DATA SHEET

24" Fridge + 24" Wine + 24" Freezer
Stainless Steel Integrated Columns

ISO VIEW OF 72" CAVITY
(24" + 24" + 24")

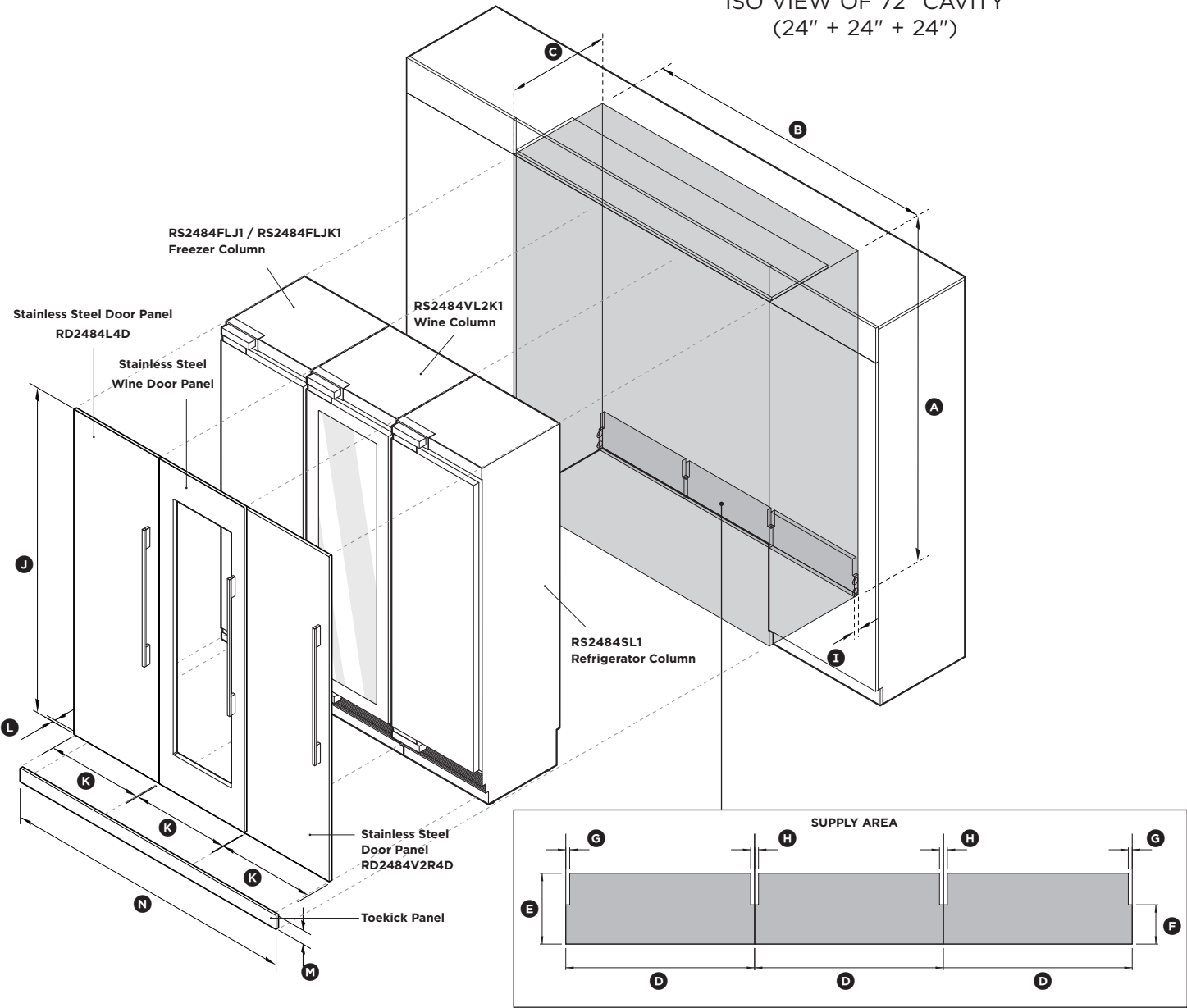

Model no:
RS2484SL1 + RS2484VR2K1 + RS2484FLJ1 / RS2484FLJK1
shown.
(refer page 3 for alternative arrangements and hinging options)
(refer page 2 for metric measurements)

IMPORTANT!
For ease of installation, ensure cavity has consistent dimensions top to bottom and left to right.

Clearance Dimensions		in
Ⓐ	Overall height of cavity	84"
Ⓑ	Overall width of cavity*	72"
Ⓒ	Minimum depth of cavity (including door panel) if: - power plug is located in an adjacent cabinet either side of group - power plug is located behind appliance	25" 25 9/16"
Ⓓ	Width of supply area behind individual fridge or freezer	24"
Ⓔ	Height of supply area	9"
Ⓕ	Height at sides of supply area	5"
Ⓖ	Width from side of supply area	1/2"
Ⓗ	Combined width in from side of supply areas	1"
Ⓘ	Depth of supply area	1"
Minimum door cabinetry gap clearance		1/8"

Optional Stainless Steel Panel Dimensions		in
⓵	Height of door panel	79 7/8"
Ⓧ	Width of individual door panel	23 3/4"
Ⓛ	Depth of door panel	3/4"
Ⓢ	Height of toe kick panel	3 15/16"
Ⓝ	Width of toe kick panel	71 13/16"

* Columns refrigerators & freezers attach directly together. No cavity divider is necessary (unless arranging hinge to hinge).

HANDLES: Handle Kits are sold separately. Shown with Contemporary Square Handle. Other style options available.

DATE: 18.03.2020

IMPORTANT NOTE: Throughout this guide, dimensions may vary by ±2mm (1/16"). Please read the installation manual for detailed information on installing the product. For full installation instructions & specifications visit fisherpaykel.com

FISHER & PAYKEL

DATA SHEET

24" Fridge + 24" Wine + 24" Freezer
Stainless Steel Integrated Columns

Model no:

RS2484SL1 + RS2484VR2K1 + RS2484FLJ1 / RS2484FLJK1
shown.

(refer page 3 for alternative arrangements and hinging options)

(refer page 1 for imperial measurements)

IMPORTANT!

For ease of installation, ensure cavity has consistent dimensions top to bottom and left to right.

Clearance Dimensions	mm
Ⓐ Overall height of cavity	2134
Ⓑ Overall width of cavity*	1830
Ⓒ Minimum depth of cavity (including door panel) if: - power plug is located in an adjacent cabinet either side of group - power plug is located behind appliance	635 650
Ⓓ Width of supply area behind individual fridge or freezer	610
Ⓔ Height of supply area	229
Ⓕ Height at sides of supply area	127
Ⓖ Width from side of supply area	13
Ⓗ Combined width in from side of supply areas	25
Ⓙ Depth of supply area	25
Minimum door cabinetry gap clearance	3

Optional Stainless Steel Panel Dimensions	mm
⓵ Height of door panel	2029
⓶ Width of individual door panel	603
⓷ Depth of door panel	19
⓸ Height of toekick panel	100
⓹ Width of toekick panel	1824

* Columns refrigerators & freezers attach directly together. No cavity divider is necessary (unless arranging hinge to hinge).

HANDLES: Handle Kits are sold separately. Shown with Contemporary Square Handle. Other style options available.

DATE: **18.03.2020**

IMPORTANT NOTE: Throughout this guide, dimensions may vary by ±2mm (1/16"). Please read the installation manual for detailed information on installing the product. For full installation instructions & specifications visit fisherpaykel.com

ISO VIEW OF 1830mm CAVITY (610mm + 610mm + 610mm)

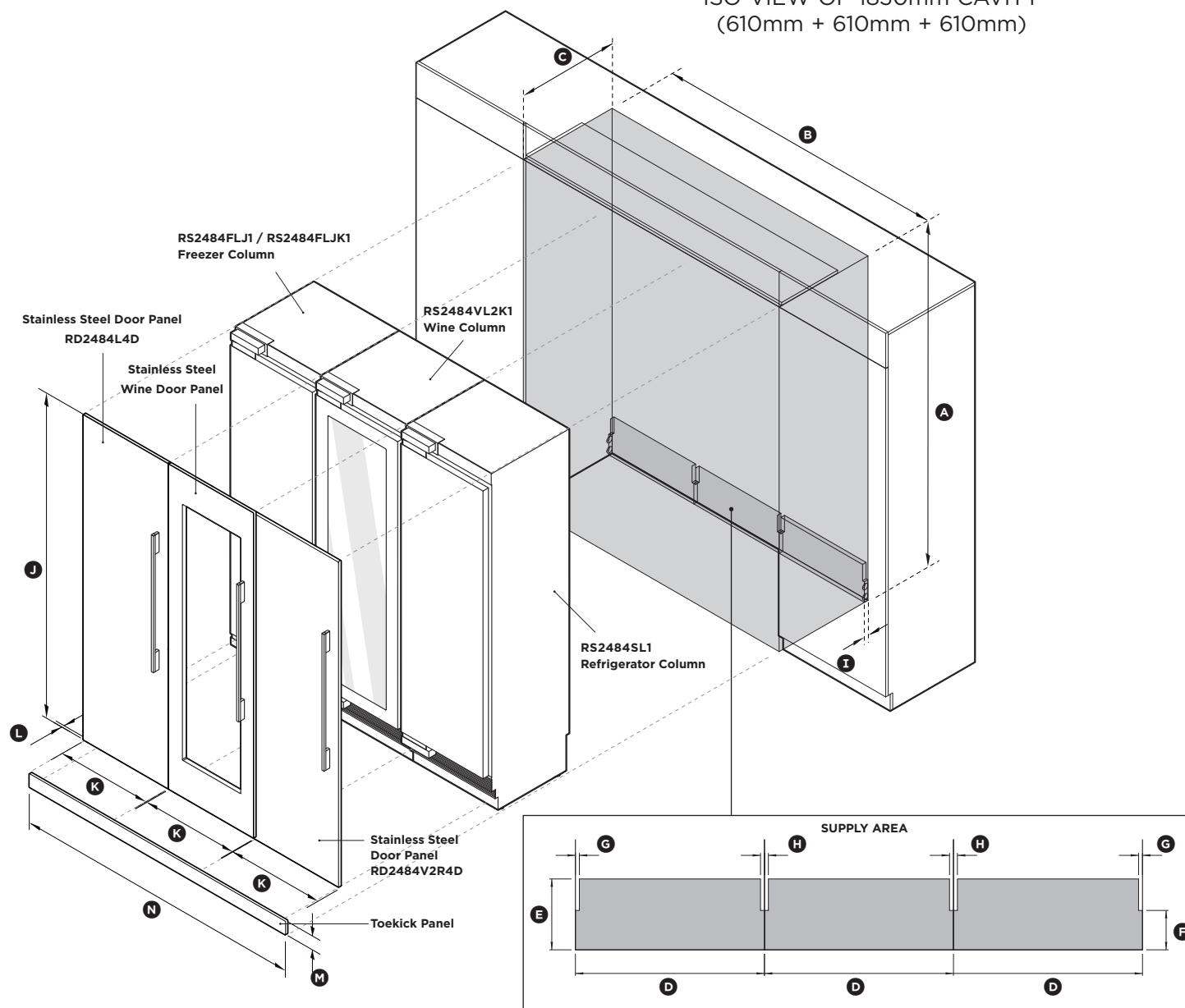

DUAL INSTALL ARRANGEMENT AND HINGE OPTIONS

The following are options for dual installation with reference to the door opening range and partition (optional) between two product combinations.

IMPORTANT!

Beware of clashing (circled) when opening the doors. Use a hinge limiting pin to restrict door opening rotation to 90° if required.

If installing a partition between two products, it should have enough clearance to ensure the doors/handles do not interfere with one another when opening or closing.

NO PARTITION

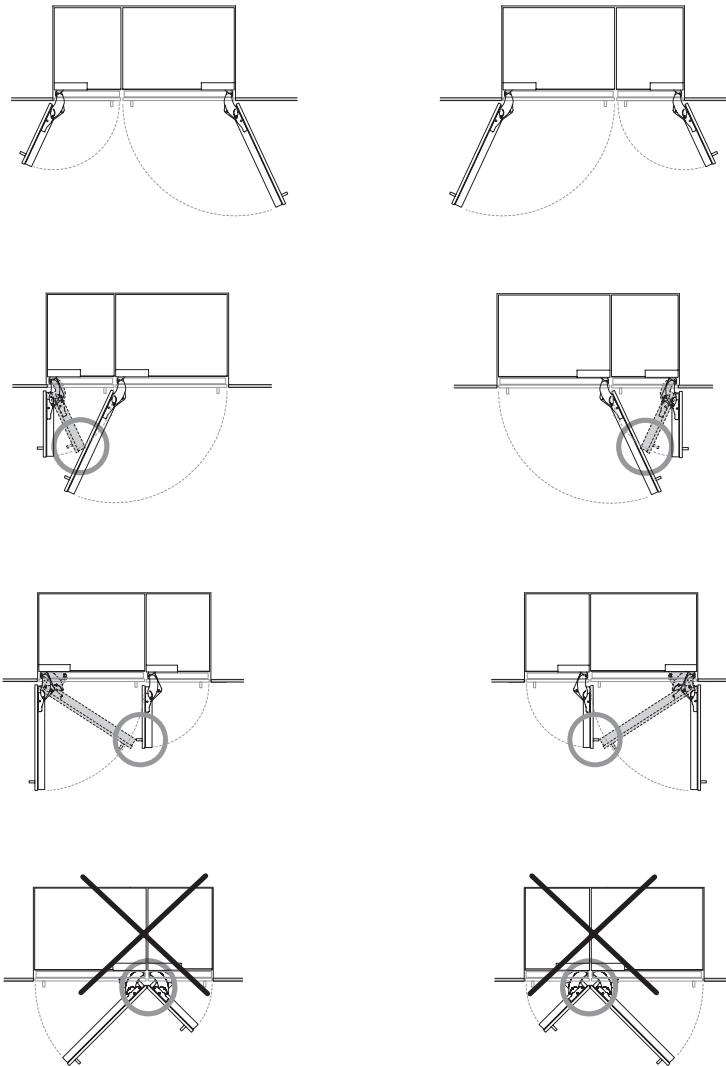

WITH PARTITION

